



# DESIGNED FROM THE OUTSIDE IN

## Design Statement

My clients approached me and suggested, unlike many others, that we remove the existing 1960's two bedroom bungalow. I needed no further encouragement.

Their brief to me was for a three bedroom, plus study home to be essentially one level, with spacious living oriented to the sun, and with good indoor-outdoor flow. It was to look interesting from the street as it is on a corner site and is reasonably prominent. The outdoor courtyard was to be private and sunny, and should contain room for a pool in the future should they wish to have one.

My clients gave me an open brief on architectural style but did ask that the house be innovative and unique.

I suggested that we use corrugated zincalume® for the roof as this would allow a low roof pitch to keep the overall profile of the house low.

I suggested to them that along with good indoor outdoor flow we should incorporate some outdoor space that was covered so there could be shade as well as shelter in more inclement weather. The long northeast facing alfresco area adjacent to the kitchen, dining and family areas has proved its worth with over 20 people seated comfortably under shelter for Christmas dinner. With a 6m wide 6 panel bi-lineal stacking sliders giving near 4m of opening from the kitchen to this space they blur the line between inside and out.

The generous double garage is set approximately 1m down from the rest of the house making access in from the street relatively level. An adjacent hard area is also a useful space for guest parking or extras such as a boat or caravan.

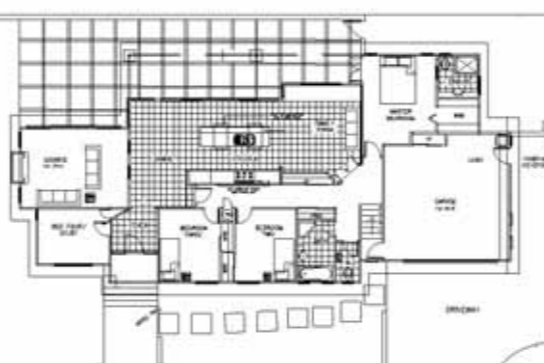

The front entry makes a striking note opposed to an otherwise restrained street elevation, leaving approaching guests in no doubt as to where the front door is.

With a muted simple duo tone colour palate on the exterior the house sits comfortably in its very suburban landscape.

The master bedroom also has access to the alfresco area by way of French doors, which gives an extension to an already generous room.

The family room has a built in window seat with storage under and a stacking slider window down to the seat level. You can sit on the seat with your back against the wall and enjoy the long vista right through the living spaces and on into the living/ courtyard.

My clients have expressed to me their pleasure in living in the house, and have found it to be very practical with the indoor outdoor flow better than they could have imagined.

## MGB Design Ltd

MGB Design Ltd pride themselves on imaginative architectural design which is unique to the site characteristics and the lifestyle or working environment of their clients.

The principle, Mark Brown, established the Auckland based company in 2000. The senior staff of MGB each have over 20 years experience and the company is committed to continued professional development in industry standards, trends and regular seminar attendance. "We consider that staying abreast with the latest developments, products, trends and good practice is vital to the success of our practice. Our clients deserve nothing less." says Mark Brown.

The practice has been commissioned on a wide variety of national and international projects but consider they have a special affinity for unique residential design with special attention to the clients individual needs and the relationship of the building to the site. To this end MGB offer their clients a wide range of design skills and complimentary expertise ranging from subdivision to interior decorating.

"We consider our success can be attributed to our innovative approach to projects from the smallest alteration to multi million dollar homes and commercial projects. The attention to detail, costing, supervision and documentation is of the highest standard ensuring our projects run smoothly", says Mark. "This is vital to our business and our clients."

*Designer: Mark Brown  
Solutions Architecture Ltd.  
Auckland.  
Telephone: 09 576 7472.  
Mobile: 0274 480317.  
E-mail:  
mark@solutionsarchitecture.co.nz  
Website:  
www.solutionsarchitecture.co.nz*

*Builder: Rob Grant  
Telephone: 027 293 6292  
Telephone/Fax: (09) 521 5002*

*Roofing Manufacturer:  
Steel and Tube Roofing  
.40 mm Custom Orb Endura®  
(corrugated) Color: Ironsand*

*Rofer: Sawden Roofing  
Unit 4, 119 Harris Road, East Tamaki  
Auckland.  
Telephone: 09 274 6415  
Mobile: 0274 707 647*

*Cladding:  
Rockcote EPS 40 Classico swirl,  
Linea Weatherboard*

*Photography: Peter Beattie*